



## Mobile stand with accessories shelf for (interactive) large format displays up to 86"

A robust anti-collision mobile stand designed for large format (Touch) displays from 55" to 86", supporting up to 100kg with VESA mounting up to 800×600mm. Ideal for classrooms, offices, and meeting rooms. The trolley comes with pre-drilled holes for quick and accurate installation. Depending on the size of the display, three mounting positions are recommended to ensure optimal viewing height.

In addition it features smooth-rolling 3-inch omni directional lockable wheels, an integrated media shelf/ accessory tray, and built-in cable management for a tidy setup. The sturdy construction ensures stability during movement and use. Designed for landscape installation (portrait supported for displays up to 700mm wide). Easy to assemble and move, it offers a reliable, flexible solution for modern mobile presentations in any indoor environment.

### 01 TECHNICAL SPECIFICATION

Number of screens	1
Screen size	55" - 86"
Max weight capacity	100kg / monitor
VESA minimum	200 x 100mm
VESA maximum	800 x 600mm
Extra	Shelf for accessories (max. 20kg), Cable management, 3-inch castor anti-collision omni directional wheels

### 02 DIMENSIONS / WEIGHT

Product dimensions W x H x D	1150 x 1602 x 665mm
Box dimensions W x H x D	1630 x 755 x 160mm
Weight (without box)	16.5kg
Weight (with box)	21.5kg
EAN code	4948570033416

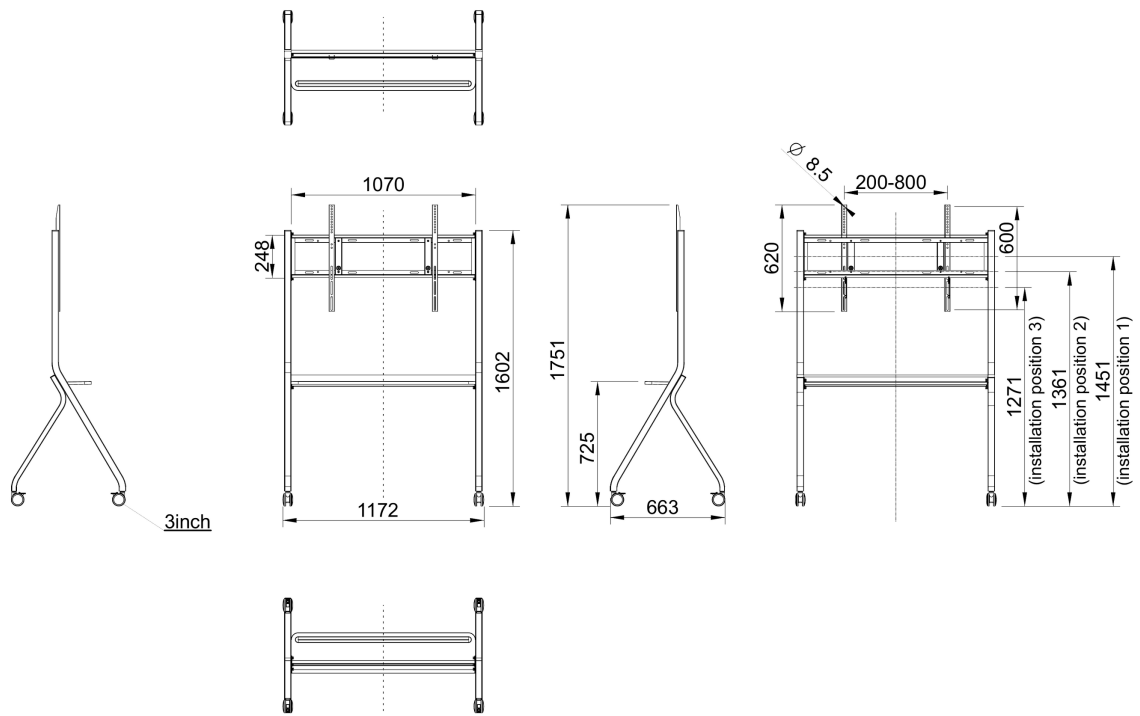

All trademarks and registered trademarks acknowledged. E & O E. Specification subject to change without notice. All LCD's comply with ISO-9241-307:2008 in connection with pixel defects.

© IIYAMA CORPORATION. ALL RIGHTS RESERVED